

Dişli Pompa Karakteristikleri / Gear Pump Use Guide

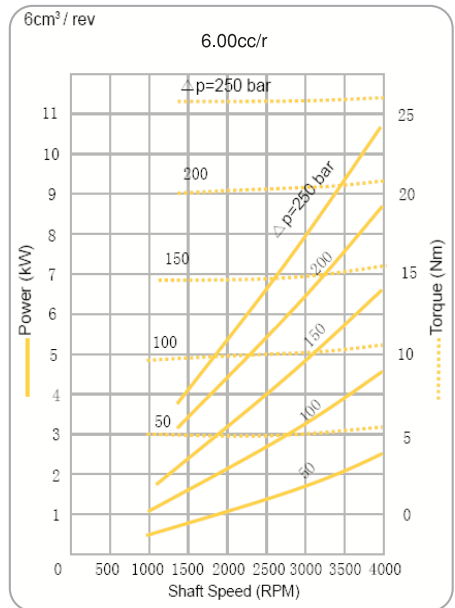

Dişli Pompa Karakteristikleri / Gear Pump Use Guide

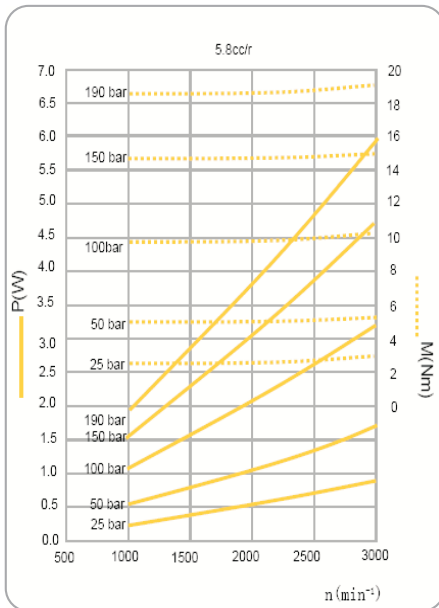
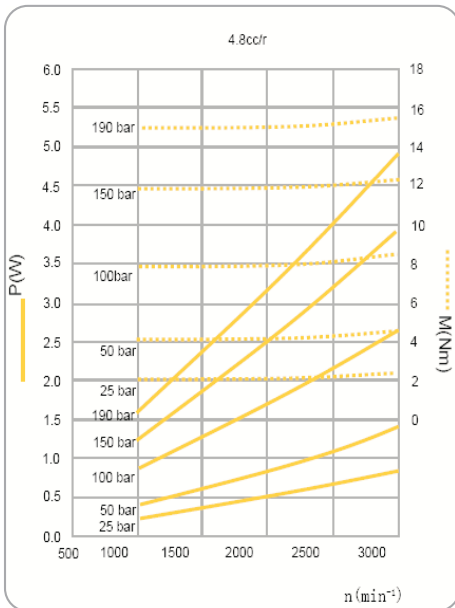
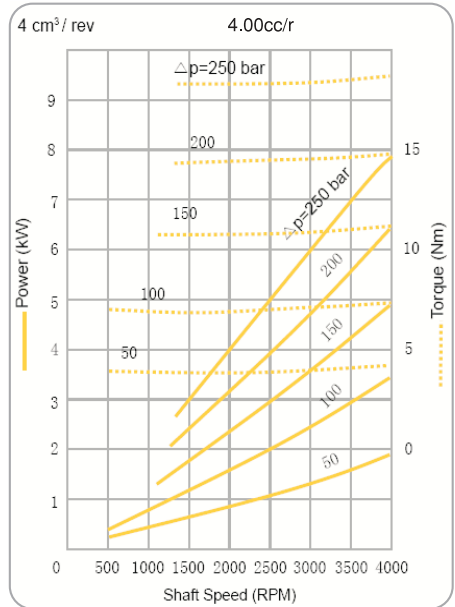
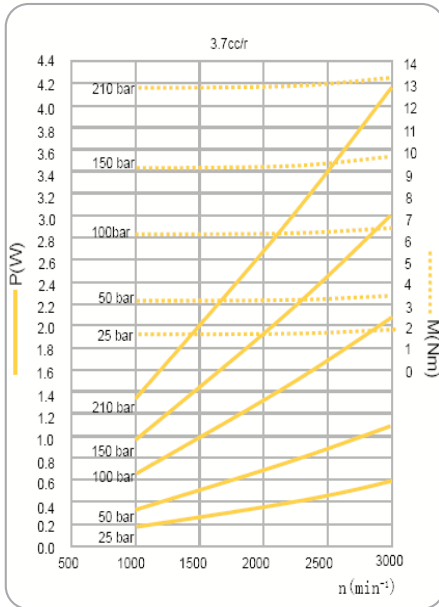
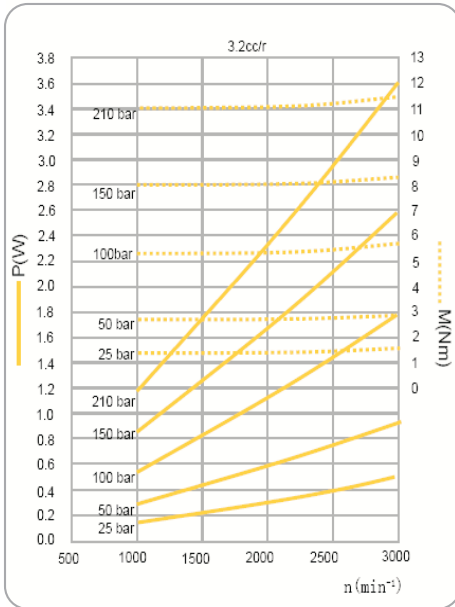
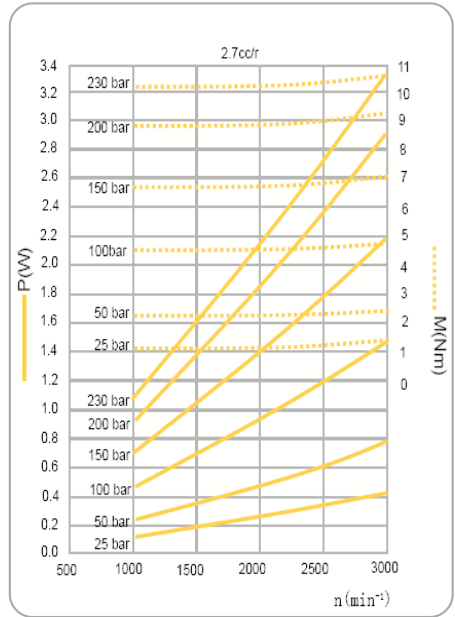
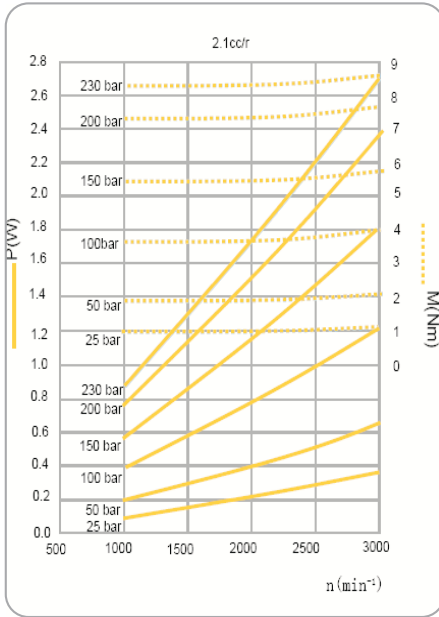
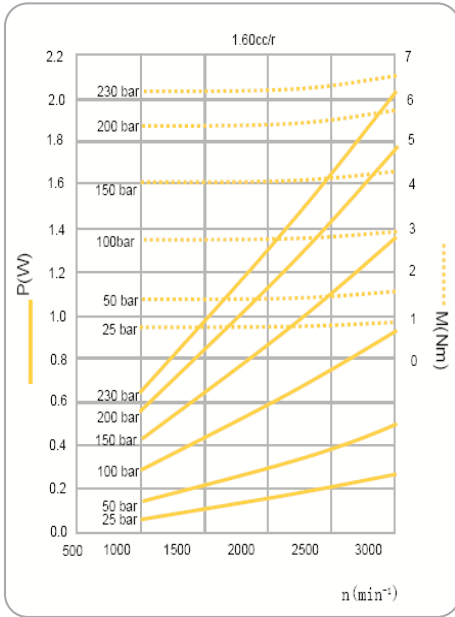
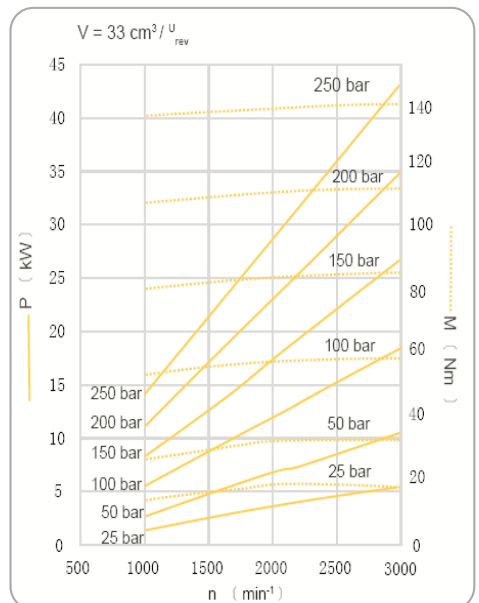
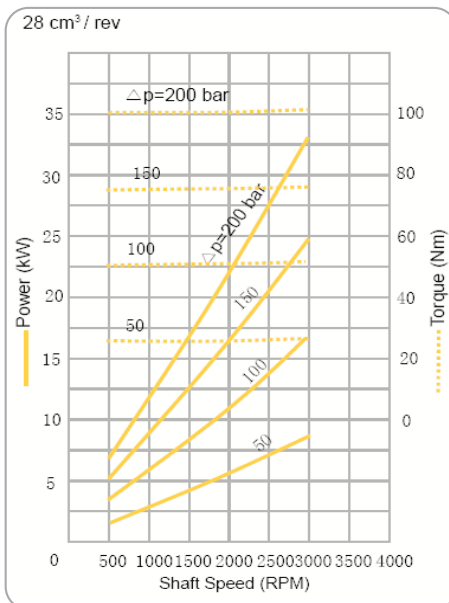
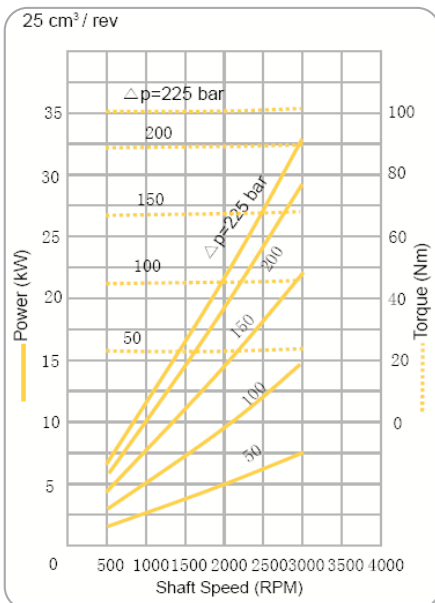
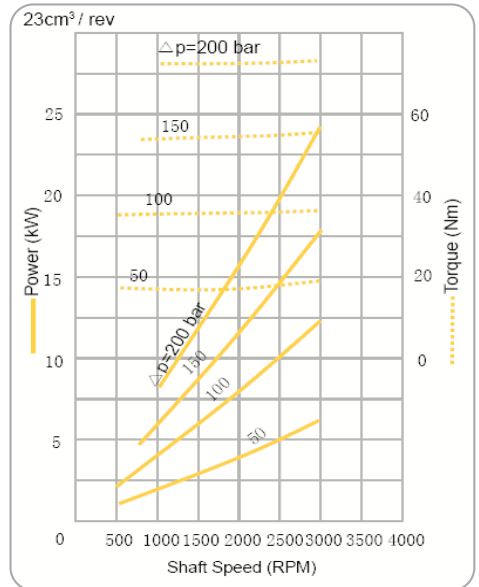
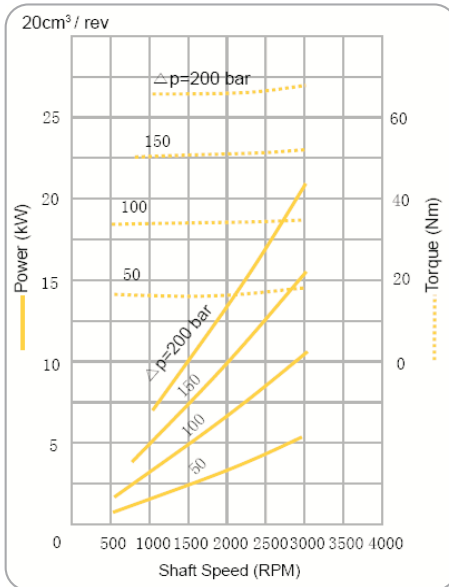
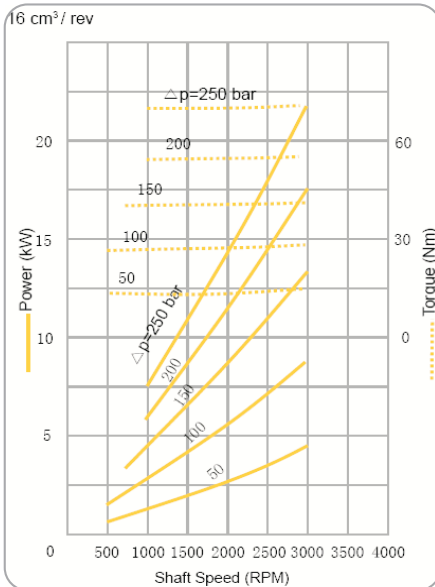
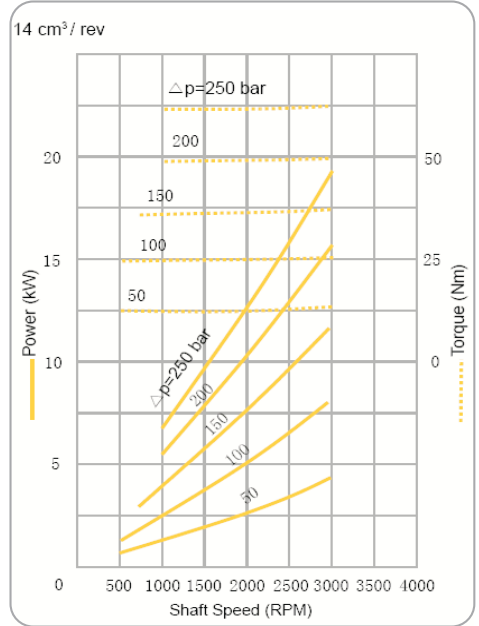
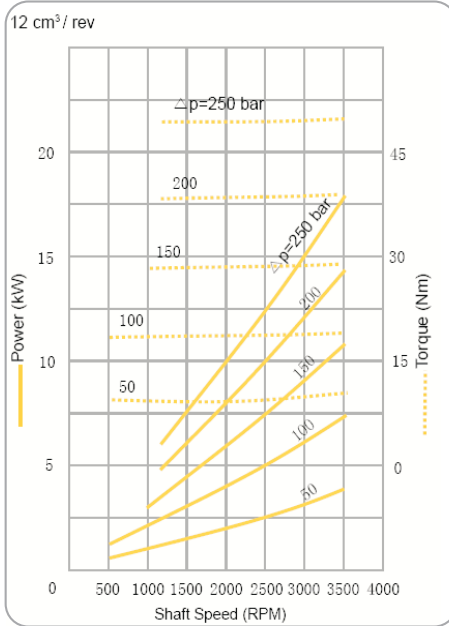
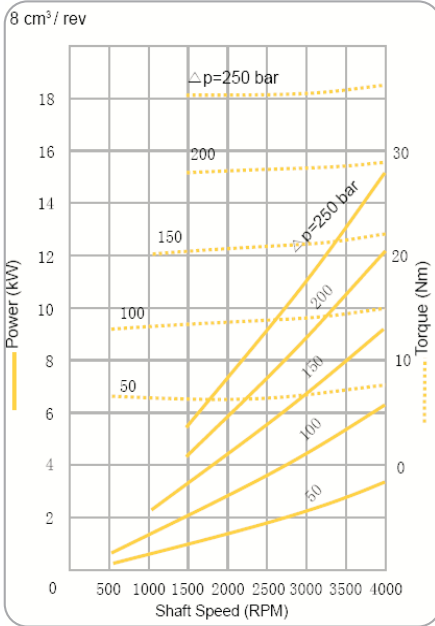

Dişli Pompa Karakteristikleri / Gear Pump Use Guide

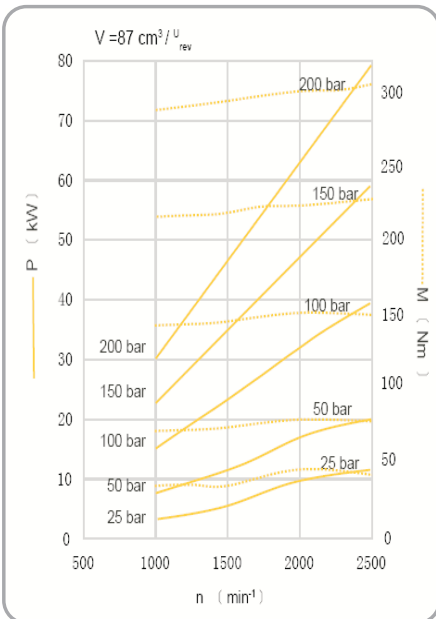
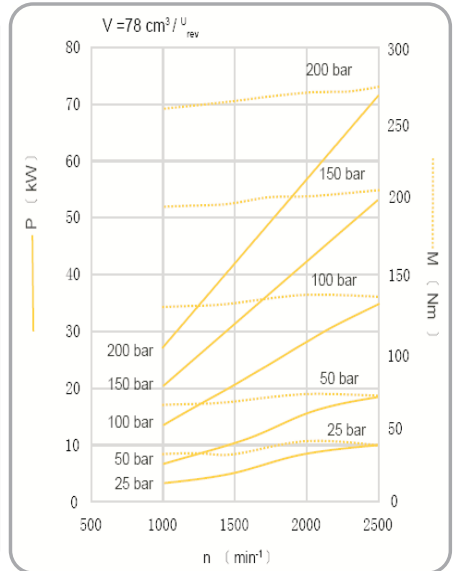
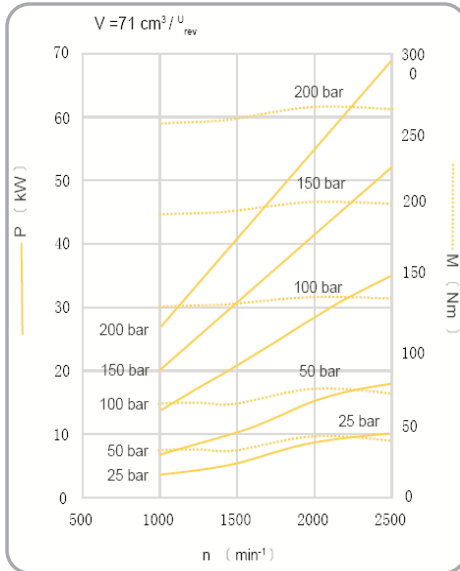
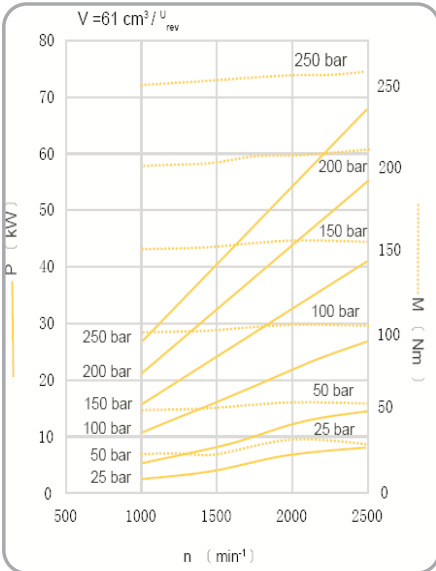
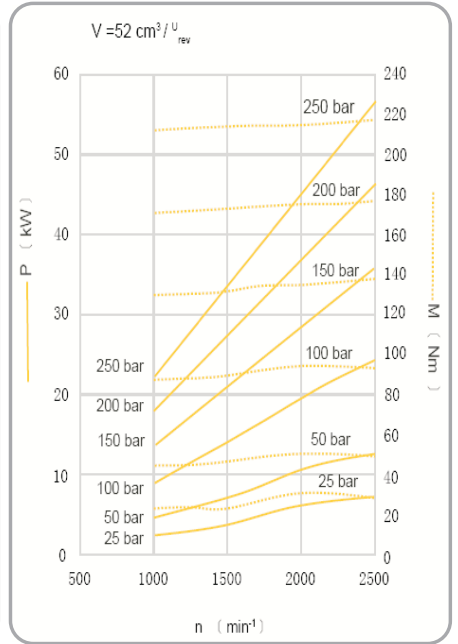
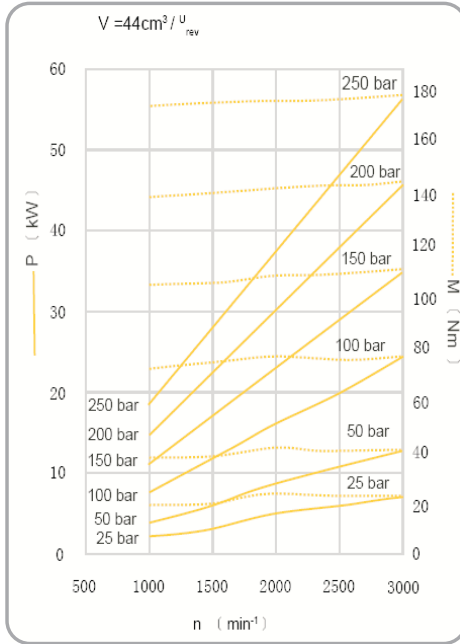
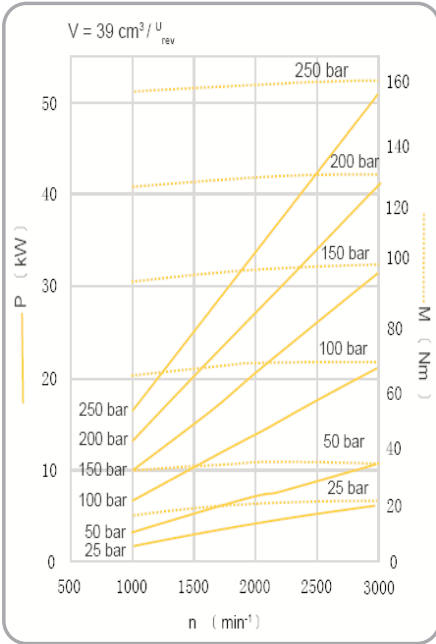

1PF***Z02****

1 Grup / Group 1



P: Dişli pompa / Gear pump

F: Basınç seviyesi / Pressure level: 200 bar

Pompa deplasmanı / Pump displacement

Emiş / basınç pozisyonu / Inlet / outlet combination

1

P

F

Z02

B

BB

Şaft ve flanş kombinasyonu / Shaft extension and flange combination



Dönüş yönü / Rotation direction:

L: sol / CCW

R: sağ / CW

Emiş / basma hattı pozisyonu / Inlet / out position combination:
SS- emiş yan ve basınç yan / Side inlet and back out.



1PF + 1PF Tandem uygulamaları mevcuttur.

1PF***Z02****

MODEL	DISP. DISPLACEMENT (ml/r)	BASINÇ/PRESSUR (bar)		DEVİR / SPEED (r/min)			L (mm)	Lt (mm)
		RATED	PİK / PEAK	RATED	MAX	Min		
1PF1.1*****Z02**	1.1	200	250	2000	6000	600	75	33
1PF1.3*****Z02**	1.3	200	250	2000	6000	600	76	34
1PF1.6*****Z02**	1.6	200	250	2000	6000	600	78	35
1PF1.8*****Z02**	1.8	200	250	2000	6000	600	78.5	35.5
1PF2.1*****Z02**	2.1	200	250	2000	6000	600	79	36
1PF2.7*****Z02**	2.7	200	250	2000	6000	600	81	37
1PF3.2*****Z02**	3.2	200	250	2000	5000	600	83	38
1PF3.7*****Z02**	3.7	200	250	2000	4500	600	85	39
1PF4.2*****Z02**	4.2	200	250	2000	4000	600	87	40
1PF4.8*****Z02**	4.8	160	200	2000	3500	600	89	41
1PF5.8*****Z02**	5.8	160	200	2000	2900	600	93	43
1PF8.0*****Z02**	8.0	160	200	2000	2100	600	101	47

1PF*L46ZO2SS**

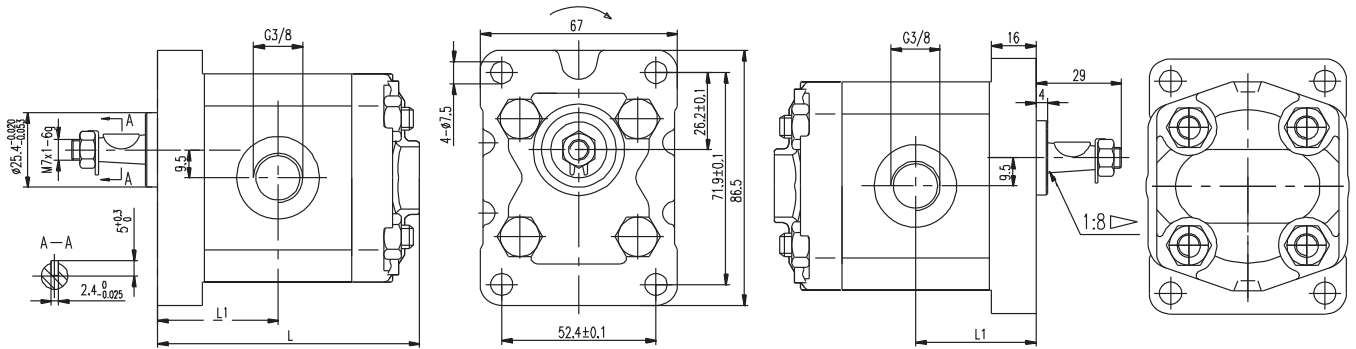

1PF*F01ZO2SS**

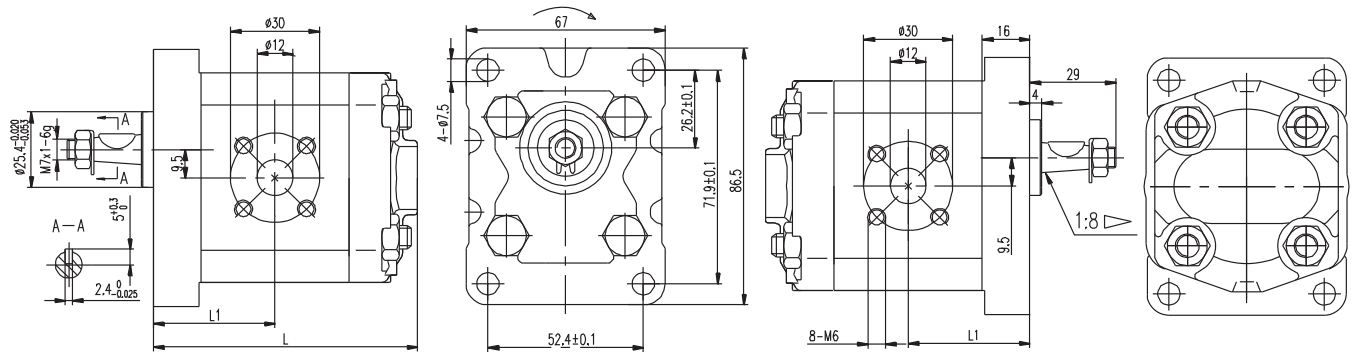

2PFL**P02***

2 Grup / Group 2



A: Döküm kapaklı / Cast iron cover

P: Dişli pompa / Gear pump

F: Basınç seviyesi / Pressure level: 200 bar

G: Basınç seviyesi / Pressure level: 250 bar

Pompa deplasmanı / Pump displacement

2

A

P

F

L**

P02

BB

Emiş / basınç pozisyonu / Inlet / outlet combination

Şaft ve flanş kombinasyonu / Shaft extension and flange combination

Dönüş yönü / Rotation direction:

L: sol / CCW

R: sağ / CW

Emiş / basma hattı pozisyonu / Inlet / out position combination:
SS- emiş yan ve basınç yan / Side inlet and back out.



2APF + 2APF Tandem uygulamaları

2APF + 1PF Tandem uygulamaları mevcuttur.

2APF**F**Z03*

MODEL	DiSP. DISPLACEMENT (ml/r)	BASINÇ/ PRESSUR (bar)		DEVİR / SPEED (r/min)			L (mm)	Lt (mm)	EMİŞ / INLET			BASINÇ / OUTLET		
		RATED	PIK / PEAK	RATED	MAX	Min			çD1	çd1	T1	çD2	çd2	T2
2APF4F02Z03*	4	200 (250)	250 (300)	2000	3500	500	95.5	43.3	30	13	M6	30	13	M6
2APF6F02Z03*	6	200 (250)	250 (300)	2000	3500	500	99	45						
2APF8F02Z03*	8	200 (250)	250 (300)	2000	3500	500	102	46.5						
2APF10F06Z03*	10	200 (250)	250 (300)	2000	3500	500	105	48	40	20	M8			
2APF12F06Z03*	12	200 (250)	250 (300)	2000	3500	500	108	49.5						
2APF14F06Z03*	14	200 (250)	250 (300)	2000	3500	500	111	51						
2APF16F06Z03*	16	200 (250)	250 (280)	2000	3500	500	114	52.5	40	20	M8			
2APF18F06Z03*	18	200 (250)	250 (280)	2000	3500	500	117.5	54.3						
2APF20F06Z03*	20	200 (250)	250 (280)	2000	3500	500	121	56						
2APF23F06Z03*	23	200	250	2000	3000	500	125.5	58.3						
2APF25F06Z03*	25	200	250	2000	3000	500	128	59.5						
2APF28F06Z03*	28	160	200	2000	3000	500	133	62						
2APF30F06Z03*	30	160	200	2000	3000	500	136	63.5						

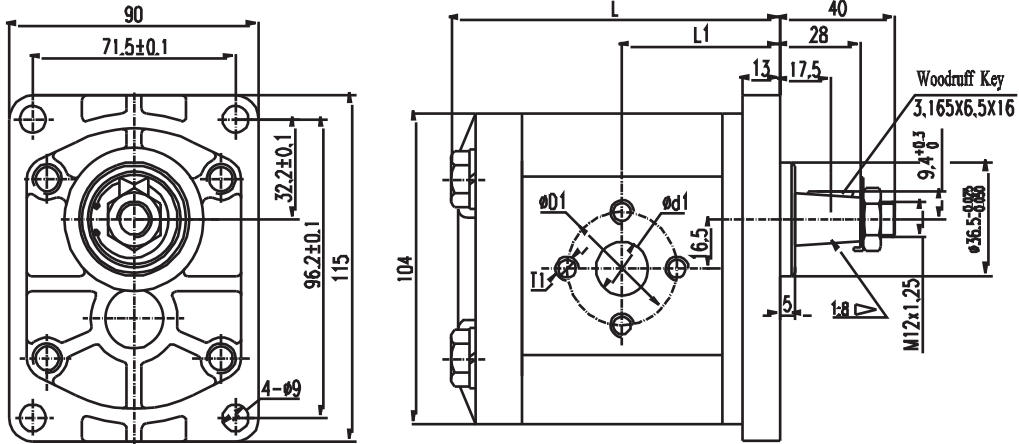

3APF**F**Z05*

3 Grup / Group 3

P: Dişli pompa / Gear pump

F: Basınç seviyesi / Pressure level: 200 bar

Pompa deplasmanı / Pump displacement

3

P

F

**

F**

Z05

*

BB

Emiş / basınç pozisyonu / Inlet / outlet combination

Şaft ve flanş kombinasyonu / Shaft extension and flange combination

Dönüş yönü / Rotation direction:

L: sol / CCW

R: sağ / CW

Emiş / basma hattı pozisyonu / Inlet / out position combination:
SS- emiş yan ve basınç yan / Side inlet and back out.



3PF + 2APF Tandem uygulaması
3PF + 2APF Tandem uygulamaları
3PF + 1PF Tandem uygulamaları mevcuttur.

3PFF**Z05***

MODEL	Disp. DISPLACEMENT (ml/r)	BASINÇ/ PRESSUR (bar)		DEVİR / SPEED (r/min)			L (mm)	Lt (mm)	øD1 (mm)	ød1 (mm)	T1 (mm)	øD2 (mm)	L (mm)	T2 (mm)
		RATED	PiK / PEAK	RATED	MAX	Min								
3PF22F10	22	200 (250)	250 (300)	2000	3000	400	128.5	65.5	56	27	M10	56	19	M10
3PF26F10	26	200 (250)	250 (300)	2000	3000	400	131.5	67						
3PF34F10	34	200 (250)	250 (300)	2000	3000	400	137	69.8						
3PF39F10	39	200 (250)	250 (300)	2000	3000	400	141	71.8						
3PF43F09	43	200 (250)	250 (300)	2000	2800	400	143.5	73	51	27	M10	51	27	M10
3PF51F11	51	200 (250)	250 (300)	2000	2400	400	149.5	76	56	27		56	27	
3PF60F12	60	180 (200)	230 (250)	1500	2800	400	156	79.3	62	33	M10	51	27	M10
3PF70F12	70	180 (200)	200 (230)	1500	2500	400	163	82.8						
3PF78F12	78	160 (200)	200 (230)	1500	2300	400								
3PF89F12	89	140 (180)	180 (200)	1500	2000	400								

